



## **Tekform Slimline Drawer**

## 2<sup>nd</sup> Generation Double Wall Drawer System



### **Sleek look**

- Narrow sides
- Efficient utilisation of drawer space

### **'EasyFix' front panel connector**

- Hand insertion
- Quarter turn lock
- Repeatable assembly and disassembly possible

### **User friendly mounting**

- Intuitive installation instructions
- Easy assembly and disassembly of the drawer

# Tekform Slimline Drawer



## Flexibility in use

- Same panel cutting dimensions as 1<sup>st</sup> generation Tekform drawer
- Same drilling specification as 1<sup>st</sup> generation Tekform drawer

## Superior vertical and horizontal stability of rails

- Smooth and silent operating
- Reliable drawer opening and closing
- Improved drawer stability in open position

## Titus damper inside

- Life-long consistent performance at various closing speeds
- 'Confident Close'
- Low pull-out force

# Tekform Slimline Drawer

2<sup>nd</sup> Generation of Double  
Wall Drawers

Tekform二代鎂鋁抽

窄版側牆鎂鋁抽

NEW



Sleek look

時尚優雅的外型

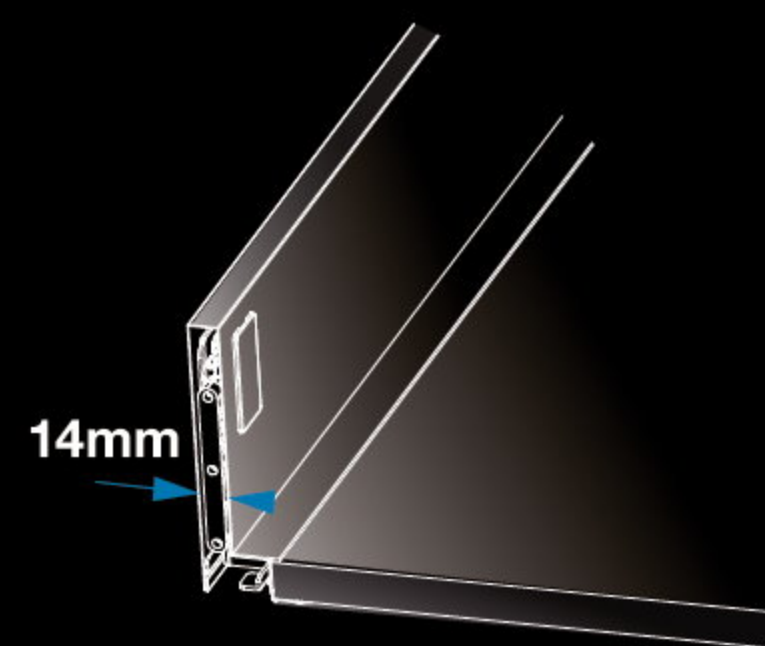

Flexibility of runner system

高適應性的滑軌系統

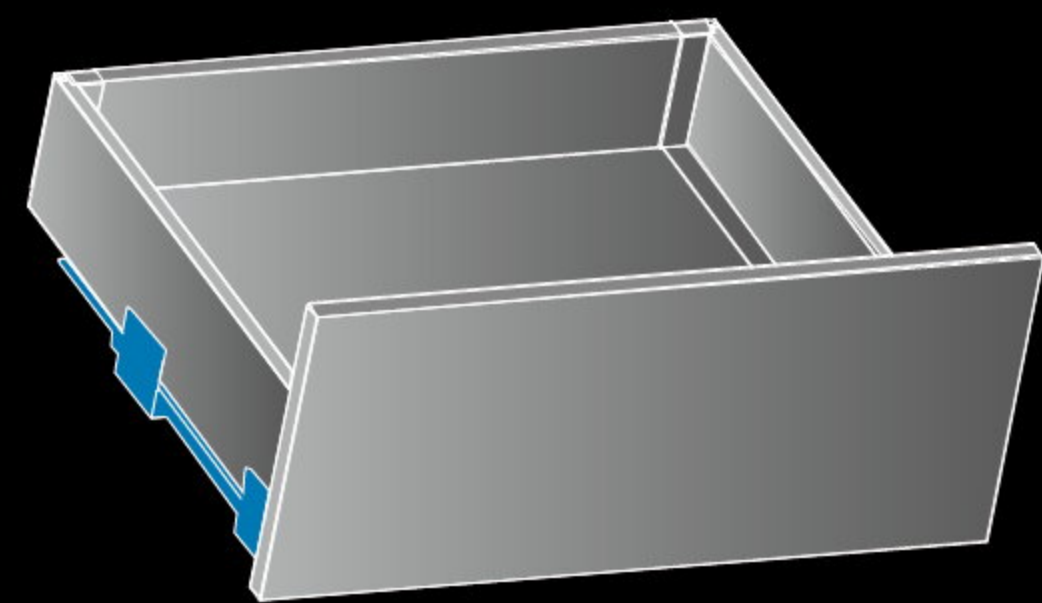

'ConfidentClose'  
with Titus damper

TITUS油壓棒帶來完美關閉



Titus damper inside  
內附TITUS油壓棒

# Tekform Slimline Drawer

## Product Guide

Page

### Tekform Slimline Drawer

Tekform slimline drawer DW70

14

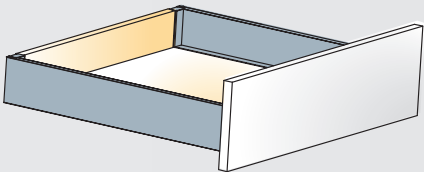

Tekform slimline drawer DW100

16

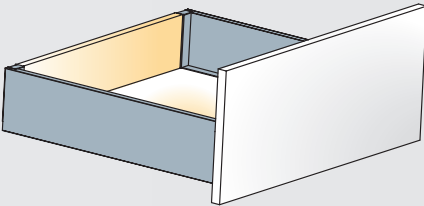

Tekform slimline drawer DW145

18

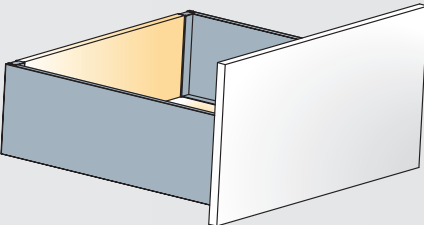

Tekform slimline drawer DW182

22

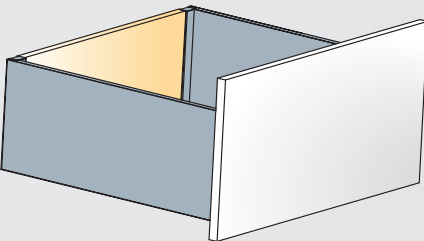

# Tekform Slimline Drawer

## Information

### Technical Guide

#### How to choose the appropriate drawer dimension?

Select the drawer size based on available cabinet space. Please refer to the chart below with indicated minimum space

required in cabinet to choose appropriate drawer system.

Tekform drawer nominal length (NL) in mm

NL	270	300	350	400	450	500	550
----	-----	-----	-----	-----	-----	-----	-----

	Tekform drawer	
	Min. height H required	Cabinet depth D
Tekform slimline drawer DW70	115mm	NL+min 3mm
Tekform slimline drawer DW100	147mm	NL+min 3mm
Tekform slimline drawer DW145	198mm	NL+min 3mm
Tekform slimline drawer DW182	230mm	NL+min 3mm

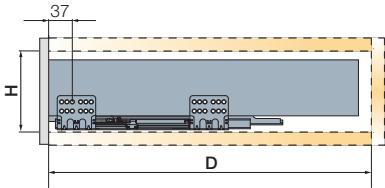

#### How to fix drawer sides to the front panel?



'EasyFix' front connector

The Tekform drawer is available with 'EasyFix' or screw-in front connectors

- hand insertion
- quarter turn locking system
- expandable plastic dowel
- easy assembly and disassembly of front panel

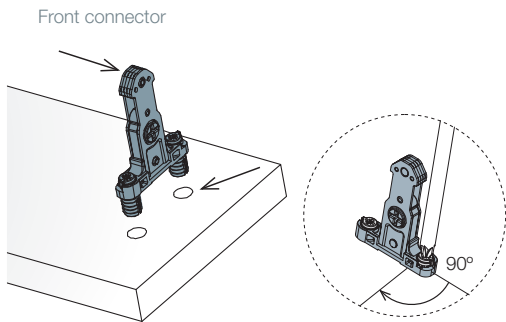

Screw-in front connector

- reliable connection
- fixing with Ø3.5x15mm screw (screws are not included)

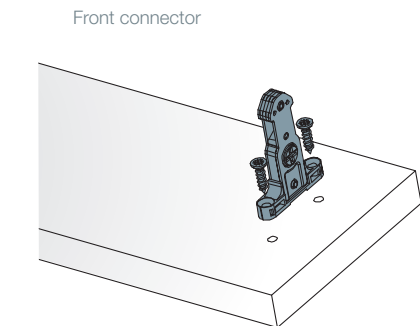

## Bottom panel and back panel cutting dimensions

Dimensions of bottom and back panel depends on:

- cabinet width
- nominal drawer length
- drawer height

Tekform drawer nominal length (NL) in mm

NL	270	300	350	400	450	500	550
----	-----	-----	-----	-----	-----	-----	-----

Cabinet width

ECW: External cabinet width  
ICW: Internal cabinet width  
NL: Nominal length of drawer

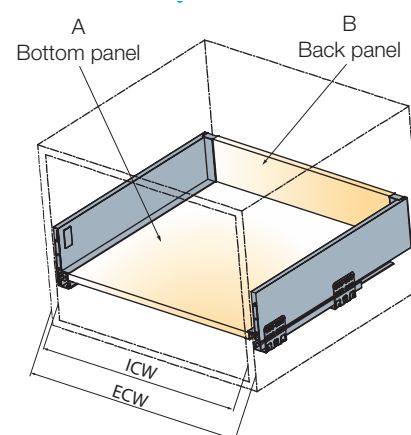

## Back panel cutting dimension

Back panel height depends on the selected drawer height

	H back panel
<b>SDW70</b>	68
<b>SDW100</b>	100
<b>SDW145</b>	151
<b>SDW182</b>	183

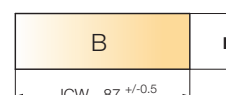

## Bottom panel cutting dimensions

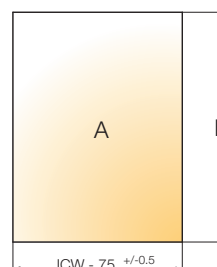

NL	270	300	350	400	450	500	550
L	260	290	340	390	440	490	540

NL= Tekform drawer nominal length (in mm)



# Tekform Slimline Drawer Information

## Technical Guide

How to choose the appropriate drawer runner fixing positions?

Drawer fixing positions depend on the chosen drawer front type.

Tekform slimline drawer with standard front

When a standard drawer front is applied, use the third hole on the drawer runner for fixing.

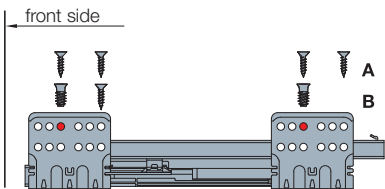

Tekform slimline drawer with inner front

When an inner drawer front is applied, use the second hole on the drawer runner for fixing.

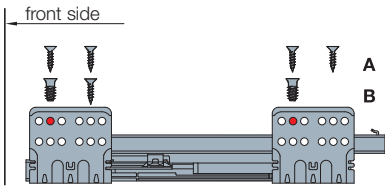

Load capacity

Drawer load capacity is 40 kg.

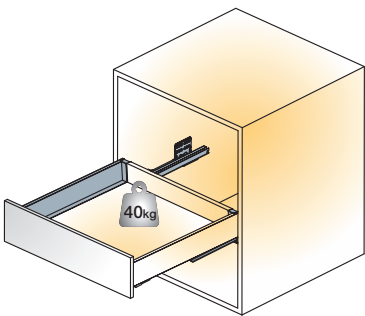

Expanded tolerances

Tekform drawers provide expanded tolerances in cabinet construction and assures:

- precise drawer alignment
- smooth and silent operating
- Improved drawer stability in open position
- Tekform drawer provides tolerance of +/- 1mm on bottom panel width size

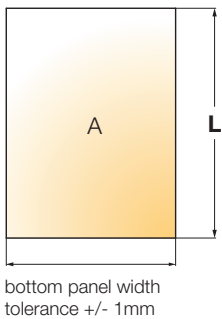





Adjustment needs to be done on both sides of the drawer

## Adjustments

### Side adjustment

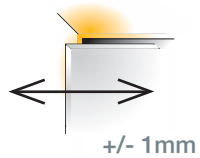

Side adjustment is done via the adjustment screw on the drawer side.

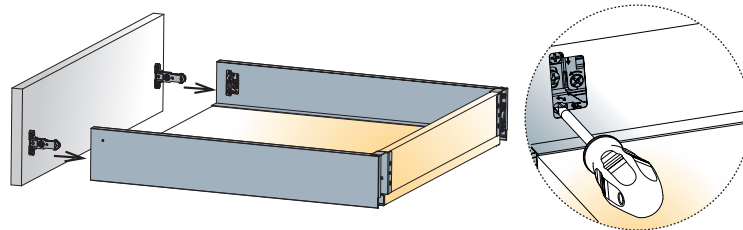

### Height adjustment

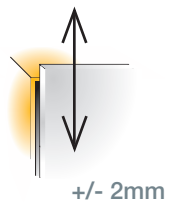

Height adjustment is done via the cam. First, release the locking screw and tighten it back after the front is adjusted.

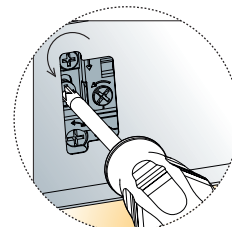
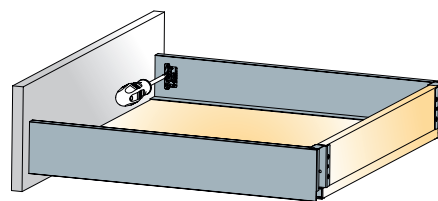

Release

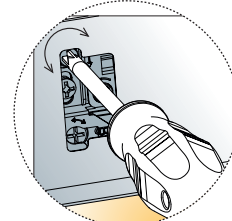
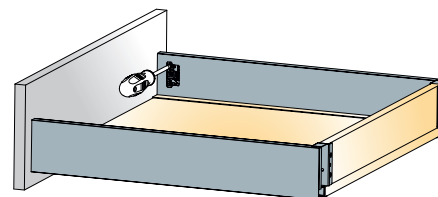

Adjust

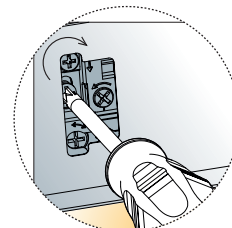
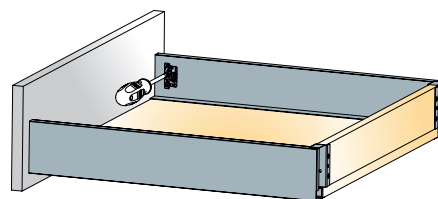

Tighten

# Key Design Choices

'ConfidentClose'

Fast closing

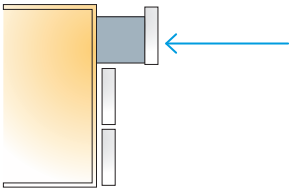

Late start of damping

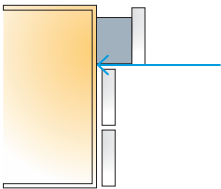

Quiet landing

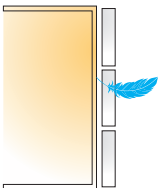

CAF Consumer Assembly Friendliness

'EasyFix' front panel connector with expandable plastic dowel provides:

- Quick, tool-free assembly
- Quarter turn lock
- Repeatable assembly and disassembly

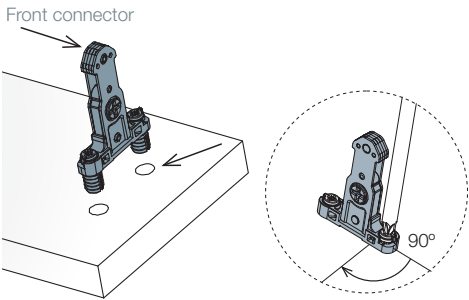

Titus hydraulic damper

Designed and produced in-house

- Reliable and consistent life-long damping
- Smooth closing
- Dampers' consistency over high volume production runs assured
- 100% automated quality check



Damping action

Even and smooth soft closing action

- Soft and reliable closing

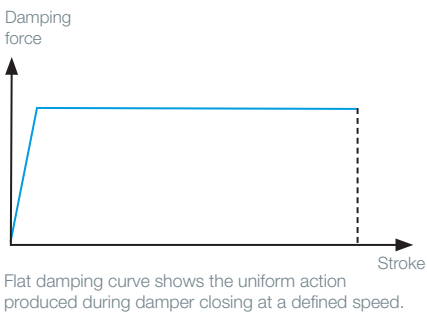

# Tekform Slimline Drawer DW70

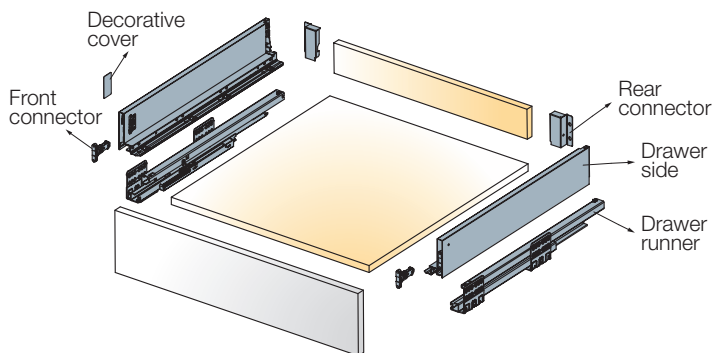
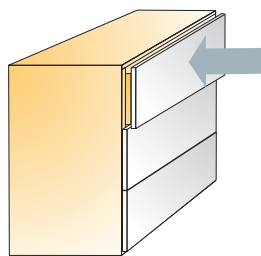

## Cutting dimensions details

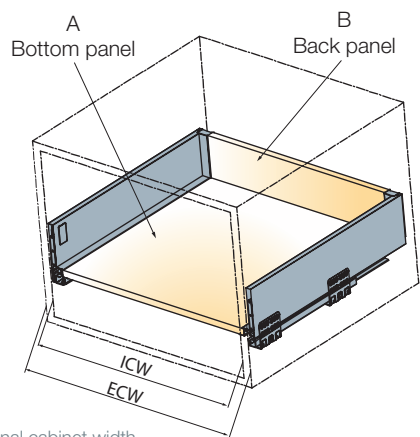

ECW: External cabinet width  
ICW: Internal cabinet width  
NL: Nominal length of drawer

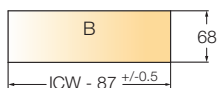
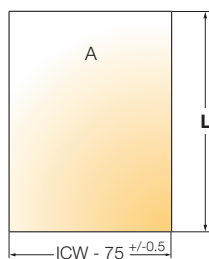

$L = NL - 10$   
For further explanation → see page 9



Nominal length (mm)	with EasyFix front connector	with Screw-in front connector		
	Item number for a set	Item number for a set	White	Anthractive grey
270	655.8T27 →	655.8E27 →	150	185
300	655.8T30 →	655.8E30 →	150	185
350	655.8T35 →	655.8E35 →	150	185
400	655.8T40 →	655.8E40 →	150	185
450	655.8T45 →	655.8E45 →	150	185
500	655.8T50 →	655.8E50 →	150	185
550	655.8T55 →	655.8E55 →	150	185
One set consists of				
Drawer sides			2 pcs	
Drawer runners			2 pcs	
*Front connectors			2 pcs	
Rear connectors			2 pcs	
Covers			2 pcs	
Mounting instructions			1 pc	

Screws are not included

- Drawer runner type
- Load capacity
- Minimum height space required
- Wooden back panel thickness
- Wooden bottom panel thickness

full extension  
40 kg  
115mm  
16mm  
16mm

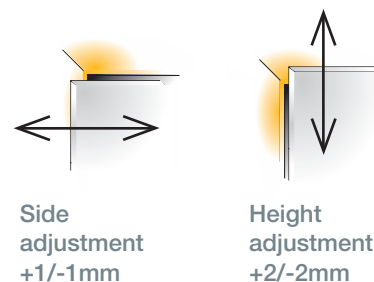

For further explanation → see page 11

#### Installation dimensions

##### Minimum space required for the cabinet

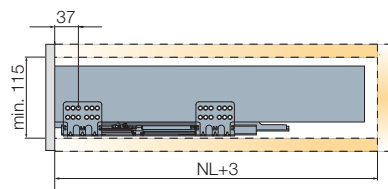

##### Drilling dimensions for the front panel

###### EasyFix attachment

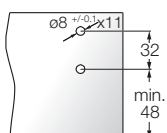

###### Screw-in attachment

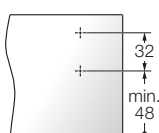

##### Mounting dimensions for the back panel

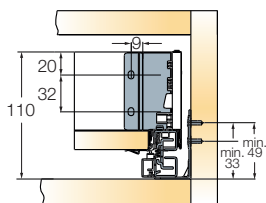

##### Installation dimensions for the front panel

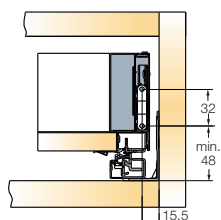

#### Drawer runner fixing positions

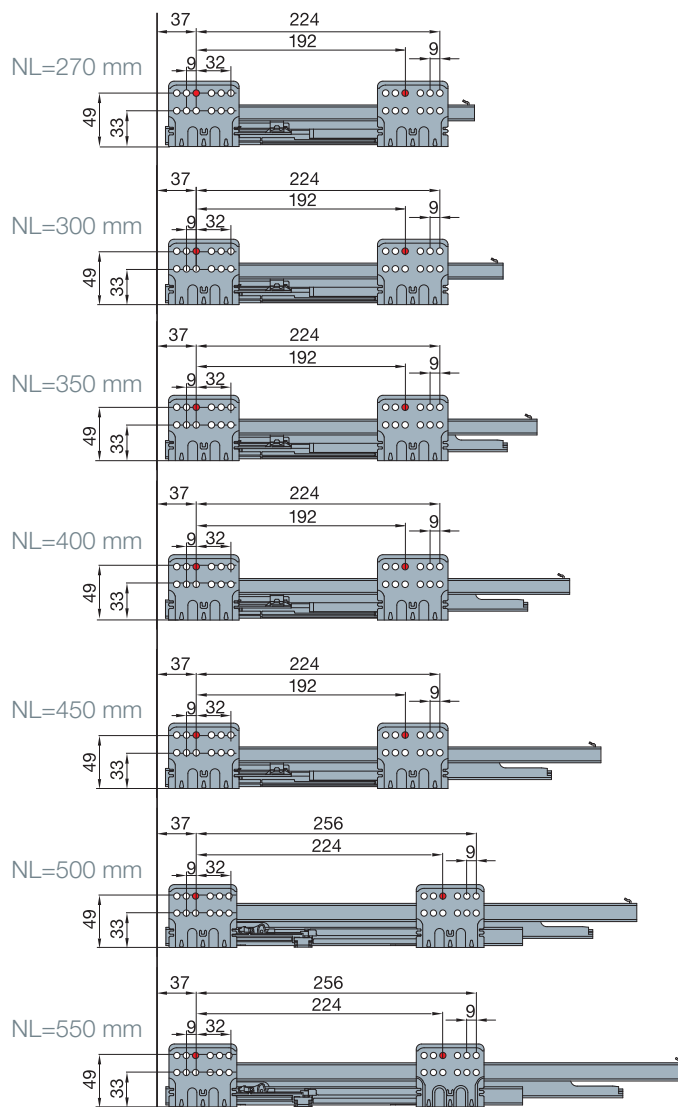
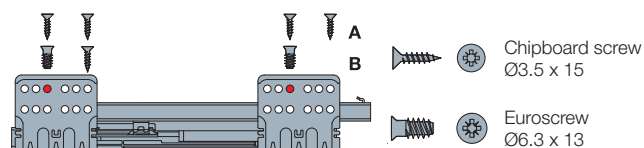

A trial mounting is always recommended.  
For further information please contact your  
Titus Group representative.

# Tekform Slimline Drawer DW100

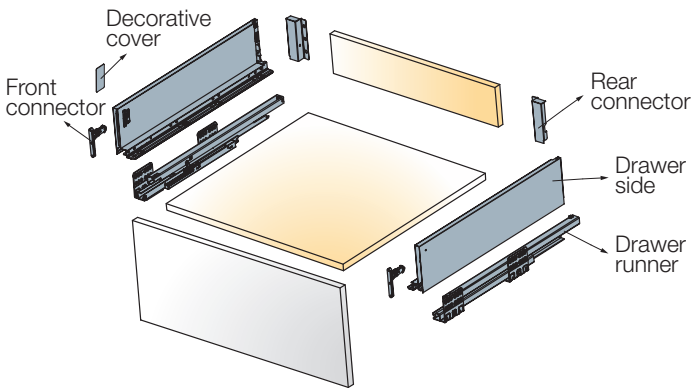
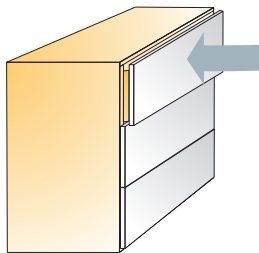

### Cutting dimensions details

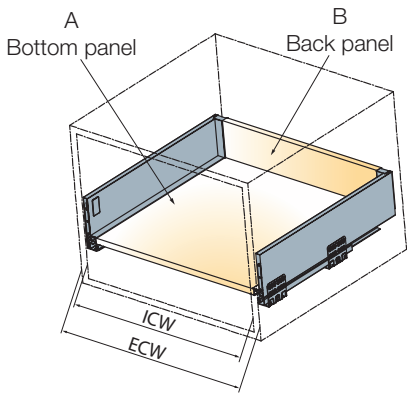

ECW: External cabinet width  
ICW: Internal cabinet width  
NL: Nominal length of drawer

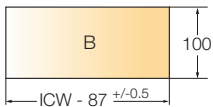
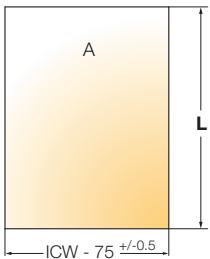

L=NL-10  
For further explanation → see page 9



Nominal length (mm)	with EasyFix front connector	with Screw-in front connector		
	Item number for a set	Item number for a set	White	Anthracite grey
270	655.8U27 →	655.8F27 →	150	185
300	655.8U30 →	655.8F30 →	150	185
350	655.8U35 →	655.8F35 →	150	185
400	655.8U40 →	655.8F40 →	150	185
450	655.8U45 →	655.8F45 →	150	185
500	655.8U50 →	655.8F50 →	150	185
550	655.8U55 →	655.8F55 →	150	185
One set consists of				
Drawer sides			2 pcs	
Drawer runners			2 pcs	
*Front connectors			2 pcs	
Rear connectors			2 pcs	
Covers			2 pcs	
Mounting instructions			1 pc	

Screws are not included

- Drawer runner type
- Load capacity
- Minimum height per drawer required
- Wooden back panel thickness
- Wooden bottom panel thickness

full extension  
40 kg  
147mm  
16mm  
16mm

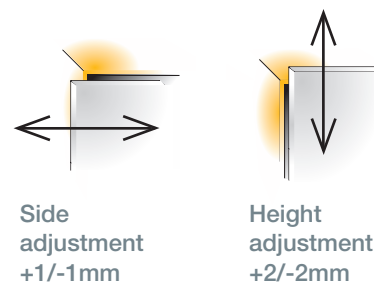

For further explanation → see page 11

#### Installation dimensions

Minimum space required for the cabinet

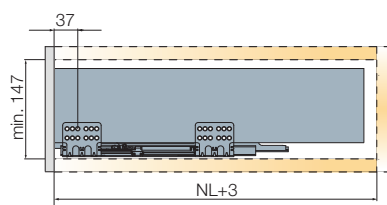

#### Drilling dimensions for the front panel

EasyFix attachment

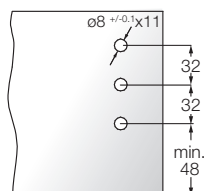

Screw-in attachment

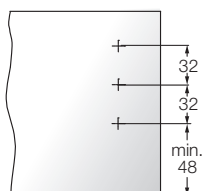

#### Mounting dimensions for the back panel

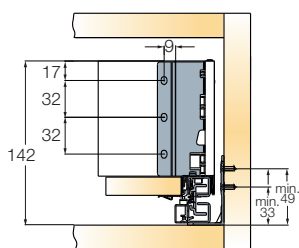

#### Installation dimensions for the front panel

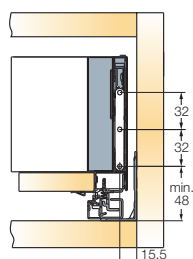

#### Drawer runner fixing positions

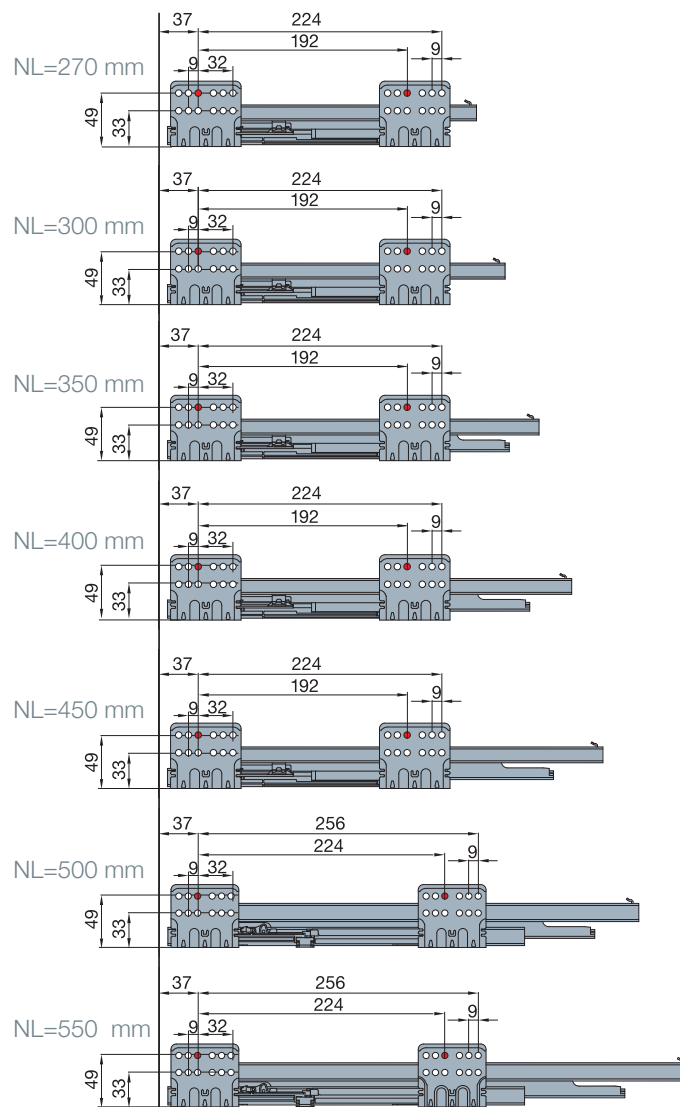
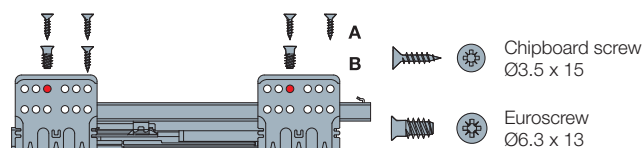

A trial mounting is always recommended.  
For further information please contact your  
Titus Group representative.

# Tekform Slimline Drawer DW145

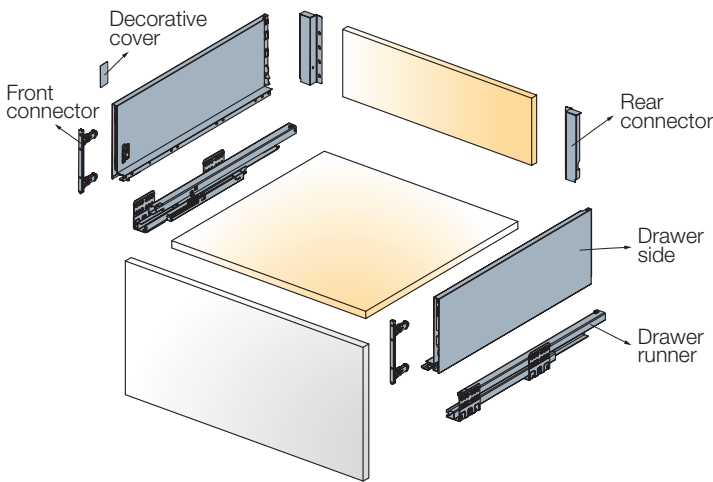
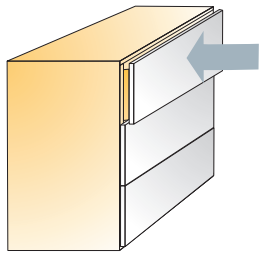

## Cutting dimensions details

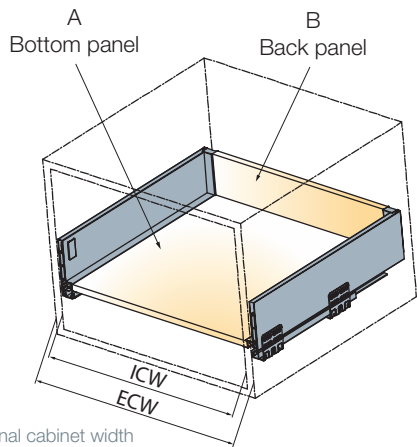

ECW: External cabinet width  
ICW: Internal cabinet width  
NL: Nominal length of drawer

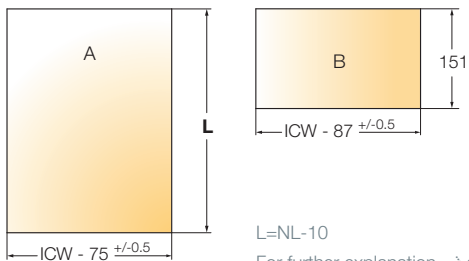

Nominal length (mm)	with EasyFix front connector	with Screw-in front connector		
	Item number for a set	Item number for a set	White	Anthractive grey
270	655.8V27 →	655.8G27 →	150	185
300	655.8V30 →	655.8G30 →	150	185
350	655.8V35 →	655.8G35 →	150	185
400	655.8V40 →	655.8G40 →	150	185
450	655.8V45 →	655.8G45 →	150	185
500	655.8V50 →	655.8G50 →	150	185
550	655.8V55 →	655.8G55 →	150	185
One set consists of				
Drawer sides		2 pcs		
Drawer runners		2 pcs		
*Front connectors		2 pcs		
Rear connectors		2 pcs		
Covers		2 pcs		
Mounting instructions		1 pc		

Screws are not included



- Drawer runner type
- Load capacity
- Minimum height per drawer required
- Wooden back panel thickness
- Wooden bottom panel thickness

full extension  
40 kg  
198mm  
16mm  
16mm

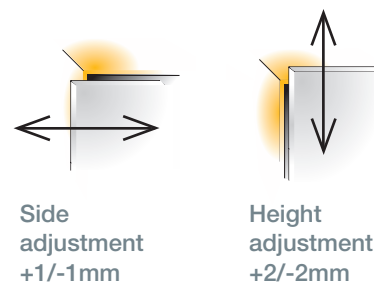

For further explanation → see page 11

#### Installation dimensions

Minimum space required for the cabinet

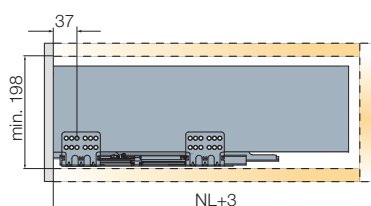

#### Drilling dimensions for the front panel

EasyFix attachment

Screw-in attachment

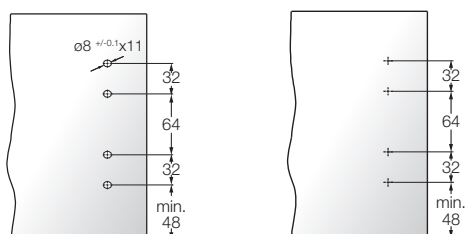

#### Mounting dimensions for the back panel

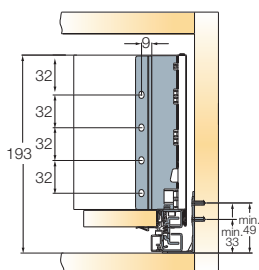

#### Installation dimensions for the front panel

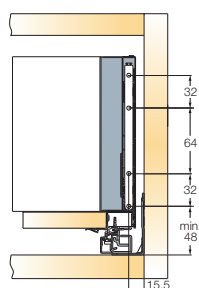

#### Drawer runner fixing positions

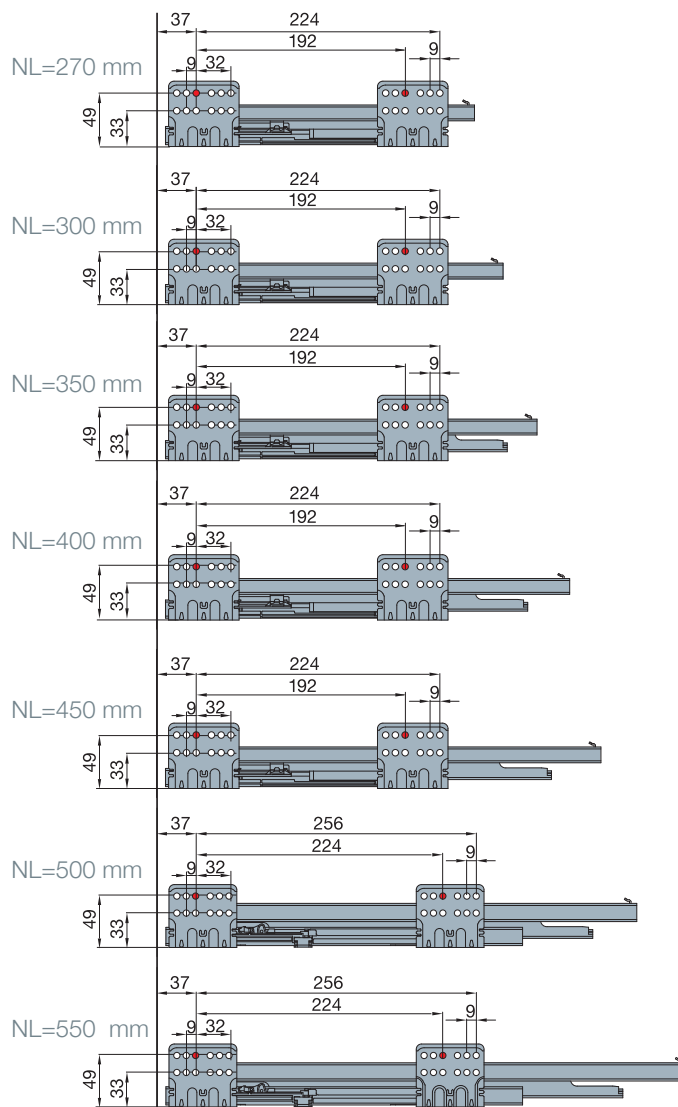
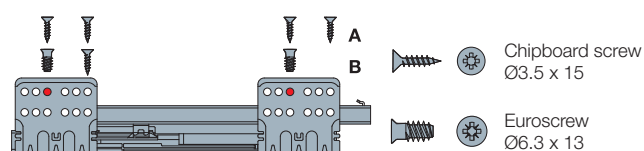

A trial mounting is always recommended.  
For further information please contact your  
Titus Group representative.

# Tekform Slimline Drawer DW182

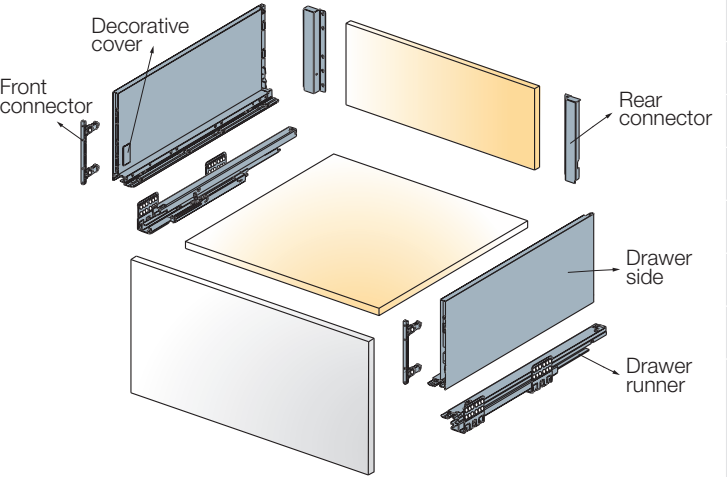
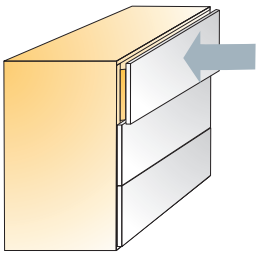

## Cutting dimensions details

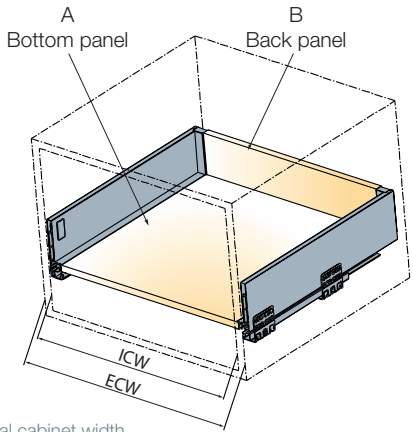



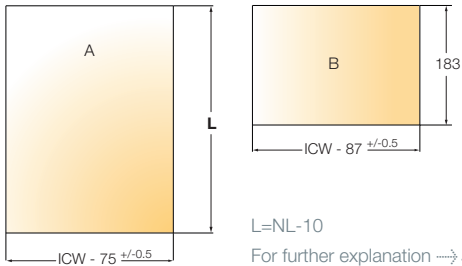

ECW: External cabinet width  
ICW: Internal cabinet width  
NL: Nominal length of drawer



L = NL - 10  
For further explanation → see page 9



Nominal length (mm)	with EasyFix front connector	with Screw-in front connector		
	Item number for a set	Item number for a set	White	Anthractive grey
270	655.8Z27 →	655.8H27 →	150	185
300	655.8Z30 →	655.8H30 →	150	185
350	655.8Z35 →	655.8H35 →	150	185
400	655.8Z40 →	655.8H40 →	150	185
450	655.8Z45 →	655.8H45 →	150	185
500	655.8Z50 →	655.8H50 →	150	185
550	655.8Z55 →	655.8H55 →	150	185
One set consists of				
Drawer sides				2 pcs
Drawer runners				2 pcs
*Front connectors				2 pcs
Rear connectors				2 pcs
Covers				2 pcs
Mounting instructions				1 pc

Screws are not included

- Drawer runner type
- Load capacity
- Minimum height per drawer required
- Wooden back panel thickness
- Wooden bottom panel thickness

full extension  
40kg  
230mm  
16mm  
16mm

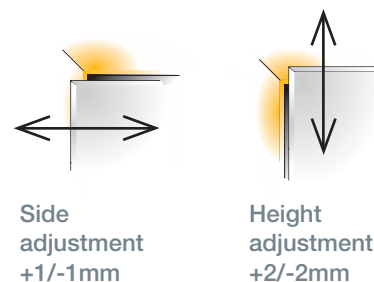

For further explanation → see page 11

#### Installation dimensions

#### Drawer runner fixing positions

##### Minimum space required for the cabinet

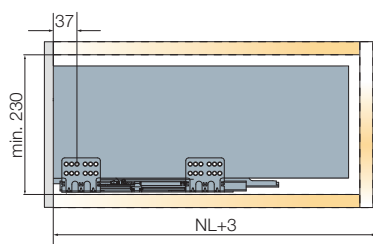

##### Drilling dimensions for the front panel

###### EasyFix attachment

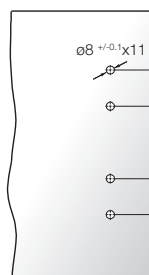

###### Screw-in attachment

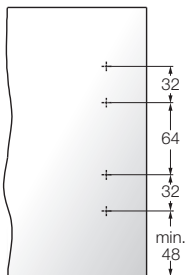

##### Mounting dimensions for the back panel

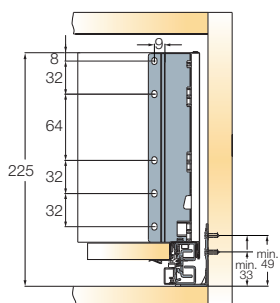

##### Installation dimensions for the front panel

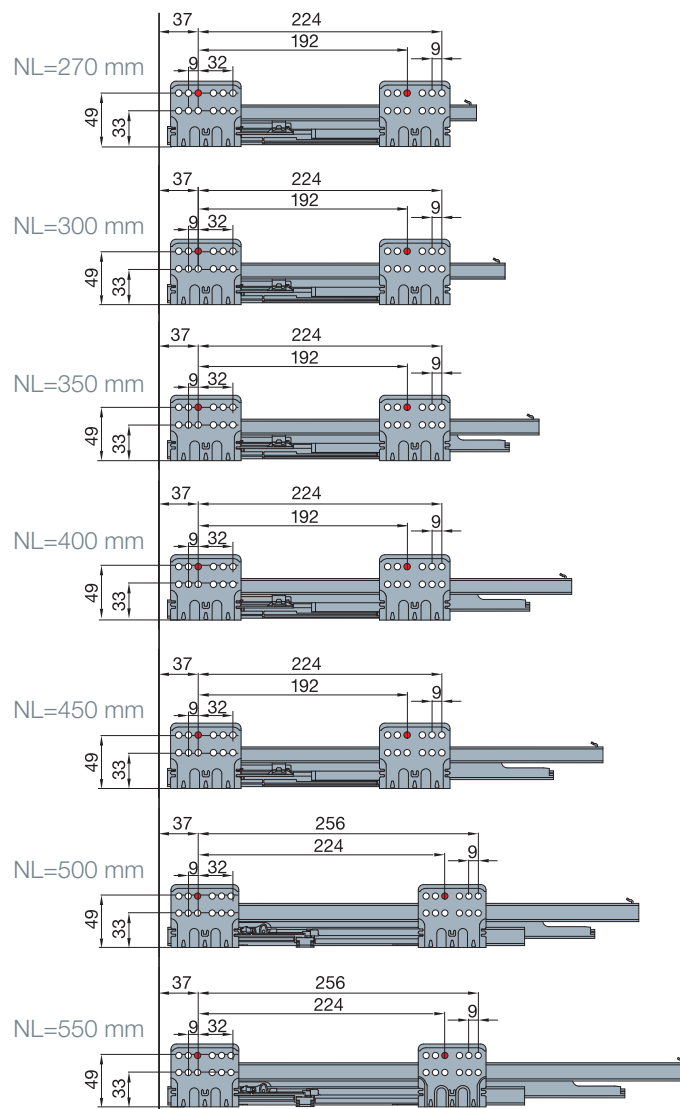
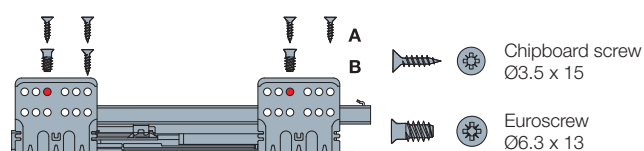
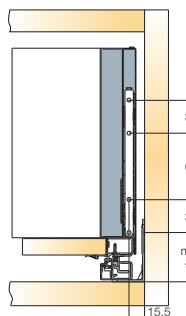

A trial mounting is always recommended.  
For further information please contact your  
Titus Group representative.



## Assembly Sequence

Connect the drawer sides to the bottom panel (1) and fix it with screws (2)

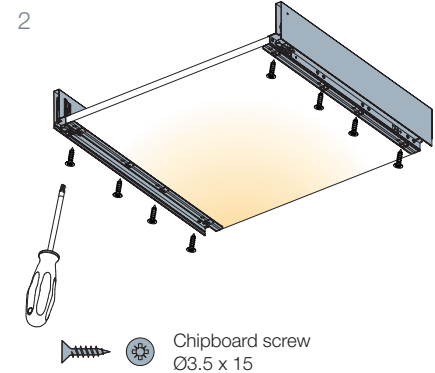
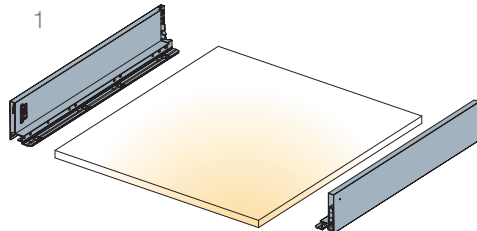

Insert the rear connector vertically (3) and push it downwards into recess in the drawer side (4)

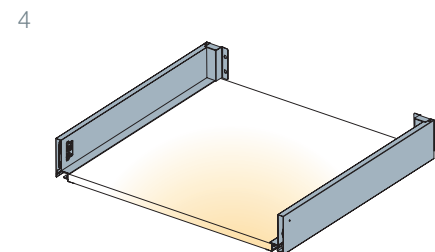
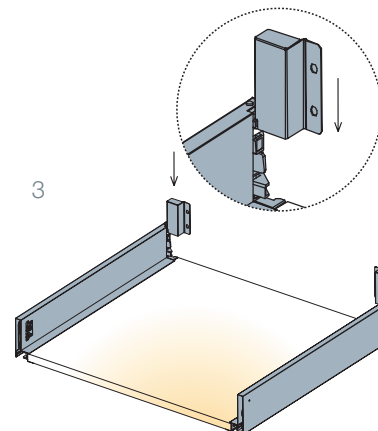

Insert the back panel (5) and fix it with screws (6)

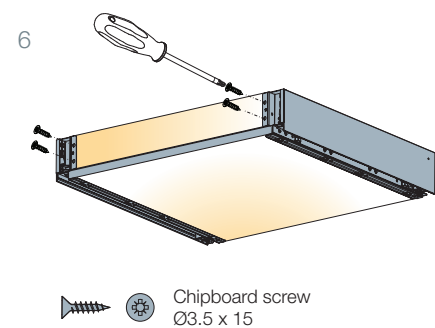
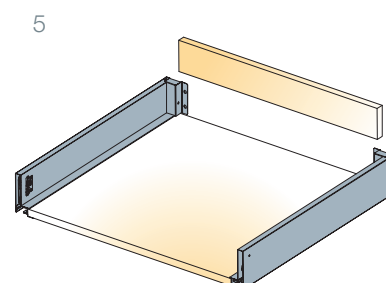



Screws are not included

## Insertion of Front Connectors

### EasyFix

Insert the front connectors into holes on the front panel

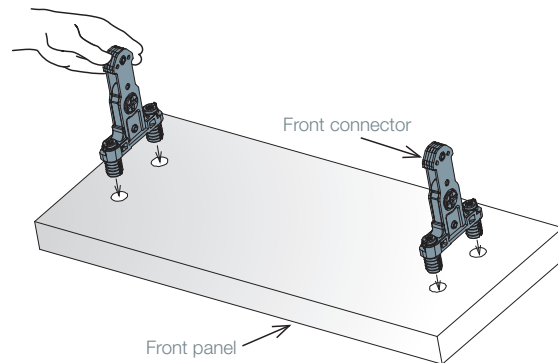

Turn the screws 90° into locked position

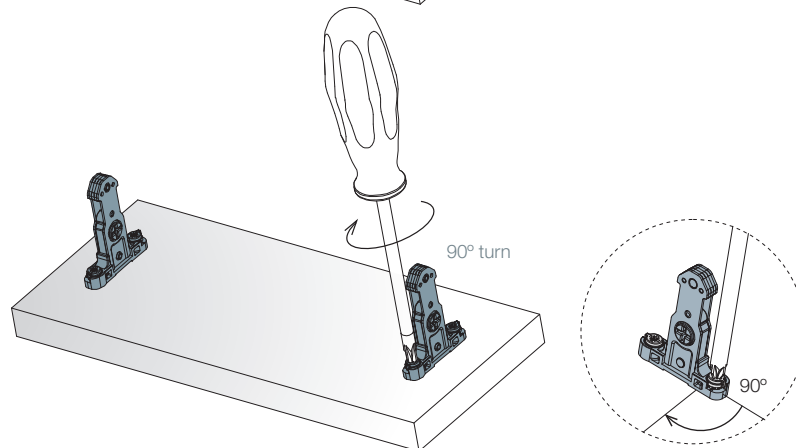

### Screw-in fixing

Use Ø3 x 15mm screws for fixing

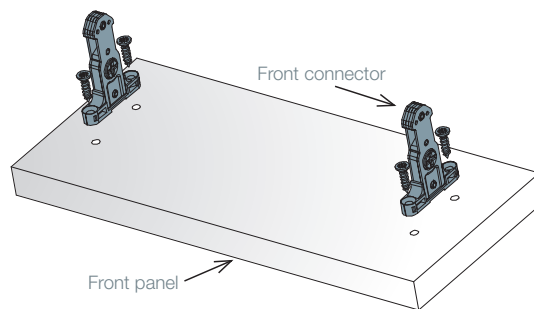

Chipboard screw  
Ø3.5 x 15

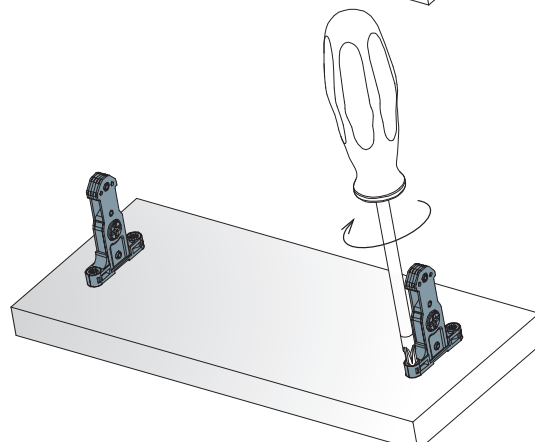

# Assembly Instructions

## Front Panel Mounting / Removal

### Mounting

Attach the front panel to the drawer and press to click

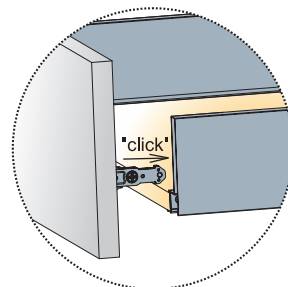
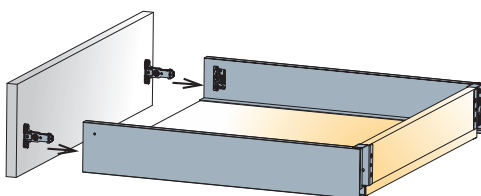

### Removal

Rotate the screw towards the front panel to disengage

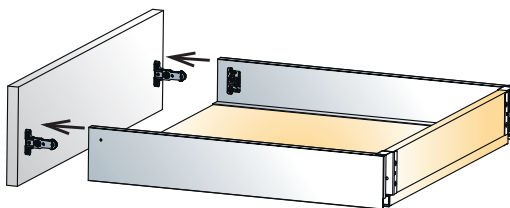
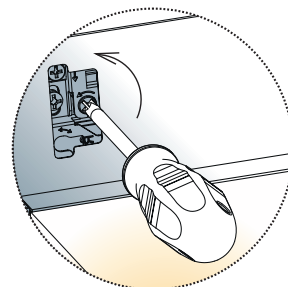
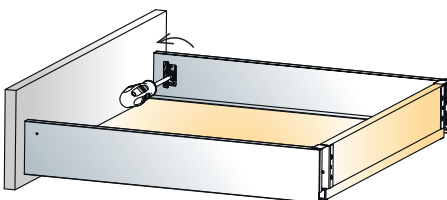

## Drawer Insertion / Removal

### Insertion

Place the drawer horizontally on the runners and push towards the cabinet until you hear the drawer is locked

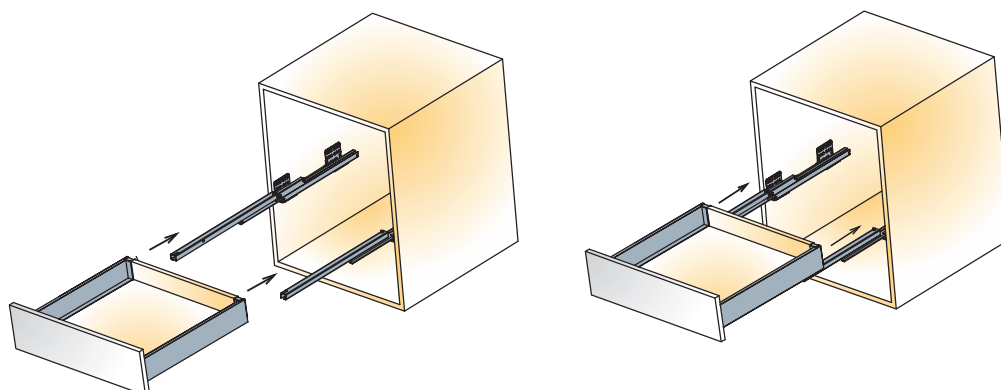

Push to fully close

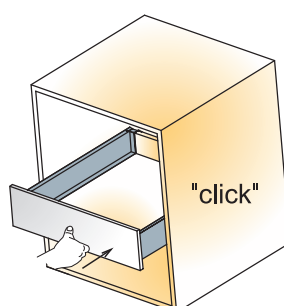

### Removal

Press-up the button under the drawer. Keep pressed to pull the drawer out

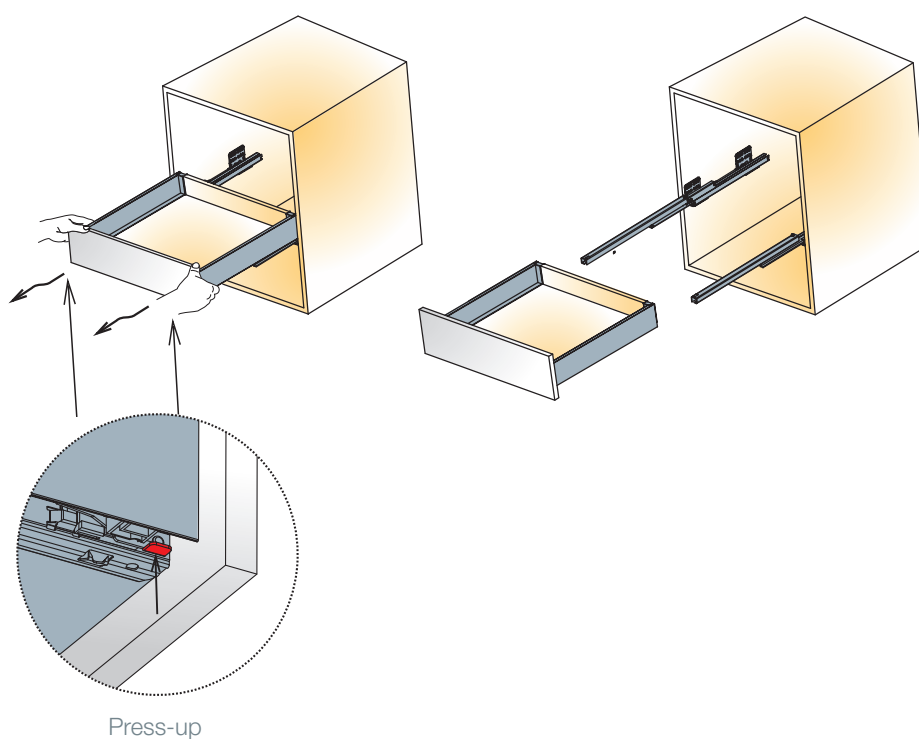

Press-up